

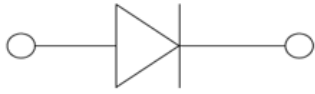

Small Signal Schottky Diode

Features

- Epoxy meets UL-94 V-0 flammability rating and halogen free
- Moisture Sensitivity Level 1
- For Surface Mount Application
- V_{RRM} 40V/30V/20V
- I_{FAV} 0.3A
- Part no. with suffix "Q" means AEC-Q101 qualified

**SOD323**

Mechanical Data

- **Case:** SOD323
- **Terminals:** Tin plated leads, solderable per J-STD-002 and JESD22-B102
- **Polarity:** Cathode line denotes the cathode end

■ Maximum Ratings ($T_a=25^{\circ}\text{C}$ Unless otherwise specified)

PARAMETER	SYMBOL	UNIT	CONDITIONS	VALUE	
Repetitive peak reverse voltage	V_{RRM}	V		SD103AWSHQ	40
				SD103BWSHQ	30
				SD103CWSHQ	20
Average Forward Current	I_{FAV}	A		0.3	
Peak Forward Surge Current	I_{FSM}	A	8.3ms, half sine	3	
Power Dissipation	P_D	mW		200	
Thermal Resistance Junction to Ambient	R_{thJA}	$^{\circ}\text{C}/\text{W}$		500	
Junction Temperature	T_J	$^{\circ}\text{C}$		-55 to +125	
Storage Temperature Range	T_{stg}	$^{\circ}\text{C}$		-55 to +125	



SD103AWSHQ & SD103BWSHQ & SD103CWSHQ

■ Electrical Characteristics (T_a=25°C Unless otherwise specified)

PARAMETER	SYMBOL	UNIT	CONDITIONS	PART	MIN	Typ	MAX
Forward Voltage	V _F	V	I _F =1mA				0.28
			I _F =10mA				0.35
			I _F =20mA				0.37
			I _F =100mA				0.48
			I _F =200mA				0.6
Reverse Current Leakage	I _R	uA	V _R =30V	SD103AWSHQ			5
			V _R =20V	SD103BWSHQ			5
			V _R =10V	SD103CWSHQ			5
Reverse Voltage Breakdown	V _{BR}	V	I _R =100uA	SD103AWSHQ	40		
				SD103BWSHQ	30		
				SD103CWSHQ	20		
Junction Capacitance	C _J	pF	V _R =0V, f =1MHz				50
Reverse Recovery Time	t _{rr}	ns	I _F =I _R =10mA, I _{rr} =1mA, R _L =100Ω				10

■ Ordering Information (Example)

PREFERRED P/N	PACKING CODE	UNIT WEIGHT(g)	MINIMUM PACKAGE(pcs)	INNER BOX QUANTITY(pcs)	OUTER CARTON QUANTITY(pcs)	DELIVERY MODE
SD103AWSHQ SD103BWSHQ SD103CWSHQ	F2	Approximate 0.0045	3000	30000	120000	7" reel



■ Characteristics (Typical)

Fig.1: PD-Ta Curve

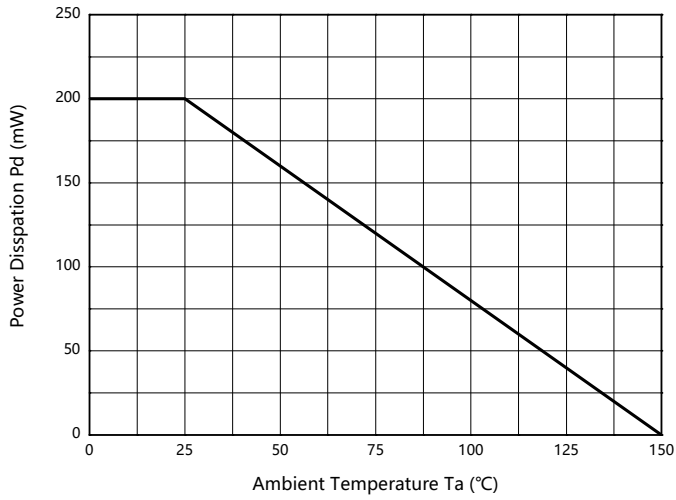

Fig.2: Capacitance Characteristics

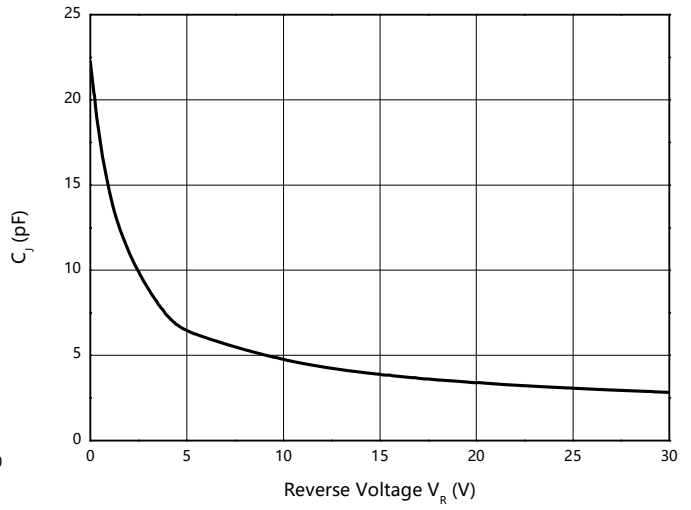

Fig.3: Forward Characteristics

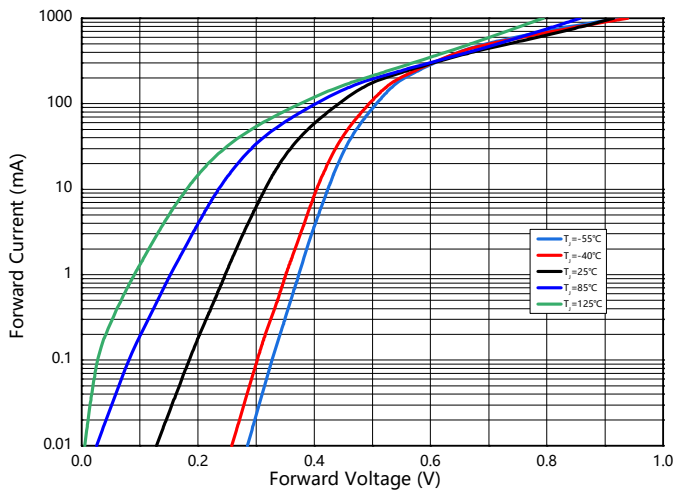
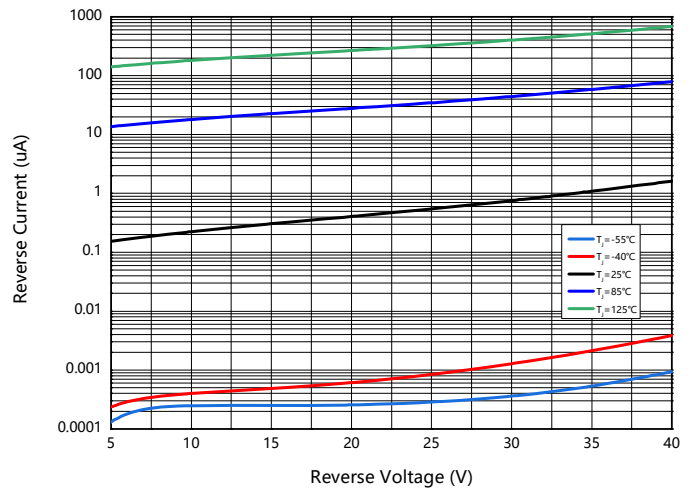

Fig.4: Reverse Characteristics





SD103AWSHQ & SD103BWSHQ & SD103CWSHQ

■ Outline Dimensions

SOD-323

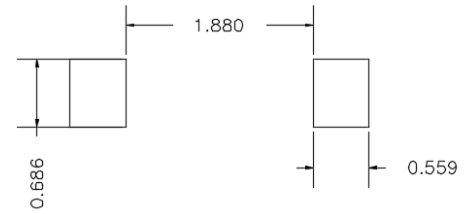
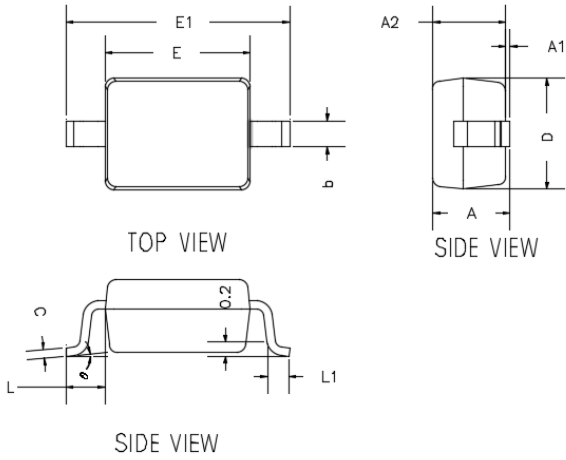

UNIT: mm

SUGGESTED SOLDER PAD LAYOUT

DIMENSIONS				
DIM	INCHES		MM	
	MIN	MAX	MIN	MAX
A	---	0.0393	---	1.0000
A1	0.0000	0.0039	0.0000	0.1000
A2	0.0314	0.0354	0.8000	0.9000
b	0.0098	0.0157	0.2500	0.4000
c	0.0031	0.0059	0.0800	0.1500
D	0.0472	0.0551	1.2000	1.4000
E	0.0629	0.0709	1.6000	1.8000
E1	0.0984	0.1063	2.5000	2.7000
L	0.0187TYP		0.475TYP	
L1	0.0098	0.0157	0.250	0.400
ϕ	0°	8°	0°	8°

NOTE:

1. PACKAGE BODY SIZES EXCLUDE MOLD FLASH AND GATE BURRS.
2. TOLERANCE 0.1mm UNLESS OTHERWISE SPECIFIED.
3. THE PAD LAYOUT IS FOR REFERENCE PURPOSES ONLY.

■ Marking Information

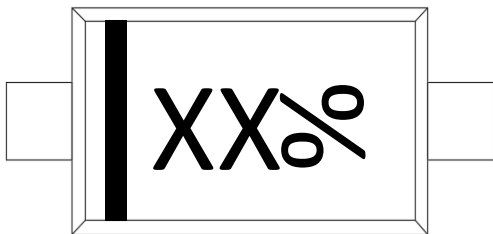

	Marking
SD103AWSHQ	S4
SD103BWSHQ	S5
SD103CWSHQ	S6

Note:

1. All marking is at middle of the product body
2. All marking is in laser marking
3. Body color: Black
4. XX is Marking Code
5. % is a date code, rotated 90° counterclockwise

*Date Code vary depending upon production date



Disclaimer

The information presented in this document is for reference only. Yangzhou Yangjie Electronic Technology Co., Ltd. reserves the right to make changes without notice for the specification of the products displayed herein to improve reliability, function or design or otherwise.

The product listed herein is designed to be used with automotive electronics, are not designed for use in medical, life-saving, life-sustaining, or military, Yangjie or anyone on its behalf, assumes no responsibility or liability for any damages resulting from such improper use of sale.

This publication supersedes & replaces all information previously supplied. For additional information, please visit our website [http:// www.21yangjie.com](http://www.21yangjie.com) , or consult your nearest Yangjie's sales office for further assistance.